

Smith
 6608 Copp
 1780-1800
 linen
 shirrey fine soft
 (11)

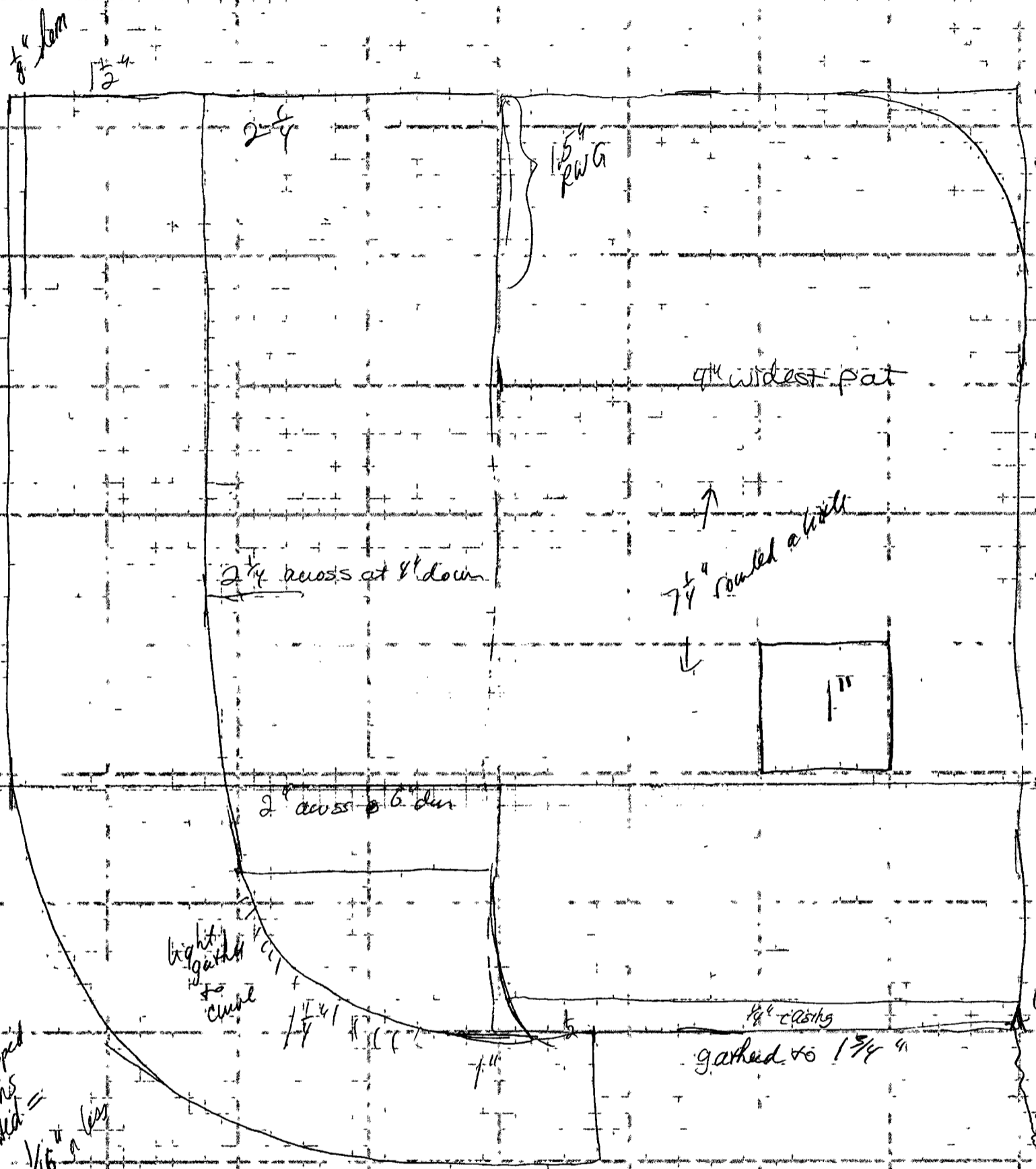

20 stitches
 minute
 2 whipped
 seams
 built =
 1/16" loss

Ruffle 9 1/4
 9 1/4

 1.8 1/2 length

4.0 } 4 1/2" gather curve, so add 4"

2 1/2 22 1/2
 4 1/2

4
 1.5

 6.0

sains

END

SMITH 6668

Light RW & around curve 6 to 9"
8" hem on out side

minute catch on side

RWG 1.5" down

center stop here

SMITH 6608

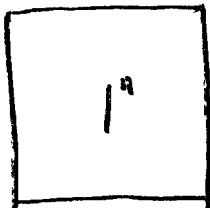

saves

inside drawing split here ↓

1/4" casing

fold

SMITH 6608

All edges minutely whipped

fold

fold